

PRODUCT DATA SHEET

ACRAB

Product typology

LED surface applique for wall and ceiling installation by a quick-fixing system, suitable for indoor and outdoor use (IP54)

Material technical spec

Housing and fixing system in white PC
 Diffuser in PC material
 A2 stainless steel screws

Color: white

Lighting technical spec

LED light source in a fixed position for a round symmetrical light throw
 Immediately ON at 100% of light flux

Wiring technical spec

Driver included

Installation and maintenance technical spec

LED light applique for direct wall or ceiling application to be installed through a quick-fixing system
 Power supply cable entry with fairlead on the backside
 For the electrical connection, use a double insulation cable Ø8-12 mm
 Quick-fixing system to be installed through 3 dowels (not included)
 No ordinary maintenance required

Technical spec

- CRI	>80	- Nominal voltage	220-240 V
- Step McAdam	<2	- Rated frequency	50/60 Hz
- Lifetime LED	30.000 h@25°C	- IP protection	IP54
- RG	0	- Power factor	>0,90
- Beam angle	120°		

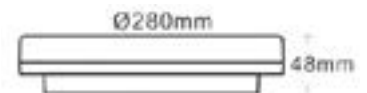
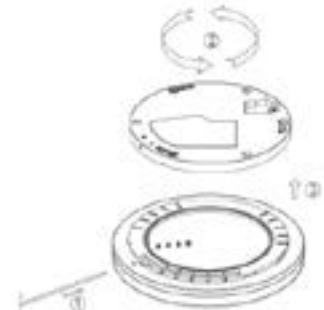

ACRAB 18W

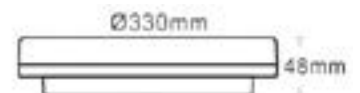

ACRAB 24W

Weight/Dimension	ACRAB 18 W	ACRAB 24 W
Net weight	720 g	850 g
Gross weight	870 g	1080 g
Luminaire dimension	Ø280xh48 mm	Ø330xh48 mm
Single packaging dimension	285x55x285 mm	335x55x335 mm
Multiple packaging (20 pcs)	585x580x310 mm (18,5 kg)	-
Multiple packaging (10 pcs)	-	570x355x350 mm (12,3 kg)

CE IP54



Photometry

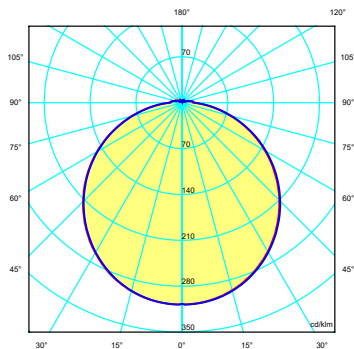

Beam angle 120°

Codice Code	Descrizione prodotto Product description	Potenza Nominale Nominal Power	Temperatura colore Color temperature	Flusso apparecchio Luminaire flux
713183	ACRAB 18W 3000K	18 W	3000 K	1.746 lm@ta25°C
713184	ACRAB 18W 4000K	18 W	4000 K	1.870 lm@ta25°C
713243	ACRAB 24W 3000K	24 W	3000 K	2.328 lm@ta25°C
713244	ACRAB 24W 4000K	24 W	4000 K	2.496 lm@ta25°C